

ATR621

Programmer 72 x 72 mm
 Programmable controller 15 cycles / 45 steps



Programmer 72x72mm, single control loop. Allows the programming of 15 cycles/programs that can provide up to 45 steps/segments, all of which can be configured by the user as raise/maintain/lower. Programming mode of the work cycle that is intuitive and simple to use even for inexperienced operators.

Step end wait software functions (in case of a delay of the process on the programmed setpoint value) and Cycle Recovery mode (after a power cut-off) are the main features of this programmer that has been specifically designed for the automation of industrial kilns, climatic chambers, dryers and the management of thermal processes in general that require the programming of cycles/curves with control of the process variable in relation to time.

Universal input and outputs that can be set as control, alarm/auxiliary and serial port RS485. All options can be configured from the keypad. MEMORY-CARD auxiliary support for the installer for quick configuration.

Main features

Box	72x72 (front panel) x 99 mm
Power supply	24...230Vac/dc $\pm 15\%$ 50/60 Hz
Consumption	5,5 VA
Display	Display 4 digit 0,5" green + Display 4 digit 0,3" red + 9 leds
Operating conditions	Temperature 0-45 °C, humidity 35...95% RH (non condensing)
Material	Box: Noryl UL94V1 self-extinguishing; Front panel: Silicon rubber V0
Weight	Approx. 250 g
Sealing	Front panel IP54 (with gasket) , Box IP30, Terminal blocks IP20
Quick set-up options	Memory Card with/without battery, software LABSOFTVIEW

Inputs

1 Analog	Selection TC, K, J, S, R, N, E, PT100, 0/4...20 mA, 0...10 V
1 Digital	1...5 cycle selection, Hold, Run, "open door" lock, Emergency

Outputs

Relays	2 / 3 Relays 8 A - 250 Vac resistive charges
Relays	1 Relay 5 A - 30 Vac
1 Analog	0/4...20mA or 0...10Volt
1 SSR	12 Vdc - 30mA max
Serial communication	RS485 Modbus RTU - Master/Slave

Software feature

Control Algorithms	ON - OFF with hysteresis, P., P.I., P.I.D., P.D. time proportioned
Autotune	Manual/Automatic
Data protection	Access to parameters by password
Alarm mode	Absolute/Threshold, band, High/Low deviation, timed auxiliary programmable for single steps.
PV/SPV retransmission	Analogue in Volt/mA or RS485 serial
Waiting function	Special function to compensate differences SPV / PV in case of overloaded system
Cycle recovery function	Resume the cycle in case of unexpected power failure
Setpoint controller mode	Regulation on a fixed setpoint (function might be enabled from general menu or during a cycle in progress)
Delayed start	Cycle start delayed by decremental timer

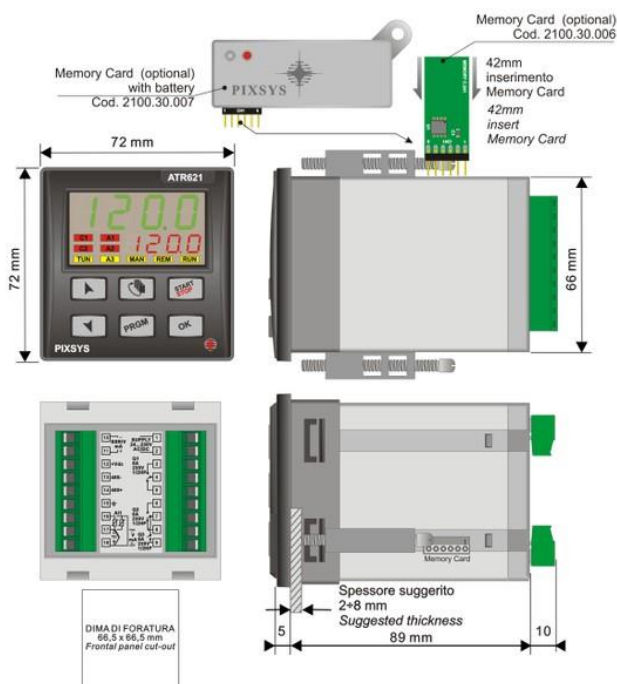

Ordering codes

ATR621-12ABC

1 Analog Input + 2 Relays 8A + 1 SSR 12Vdc + 1 Digital Input, 24...230Vac/dc

ATR621-13ABC-T

1 Analog Input + 3 Relays 8A + 1 Output V/mA/SSR + RS485, 24...230Vac/dc

ATR621-14ABC

1 Analog Input + 3 Relays 8A + 1 Relay 5A (30V) + 1 Digital Input, 24...230Vac/dc

DYNATIME SA